

# G-SHOCK

## PAPER CRAFT

This model was designed for paper craft and may differ from the original in some respects.

Scale **1/1**

### DW-5600 Assembly instructions



Mountain fold  
(dashed line)



Valley fold  
(dotted and  
dashed line)

← Insert

← Apply glue



Cut out

#### 1 Tools & Materials

- A4 plain paper
- Utility knife
- Scissors
- Utility knife board
- Glue or glue tape

#### 2 Cut out all the parts

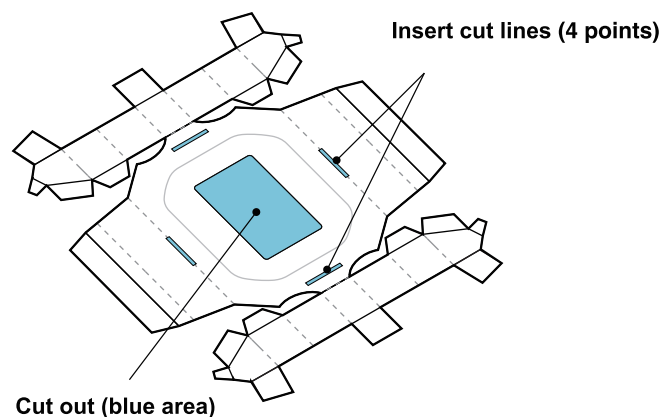

#### 3 Assemble the case

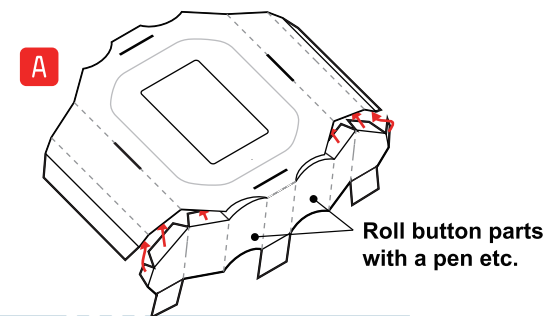

Tips for toughness structure

##### Unchangeable square design

Rectangular form was devised as the optimal shape for shock-resistant construction.

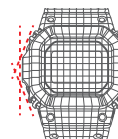

#### 4 Assemble the bezel

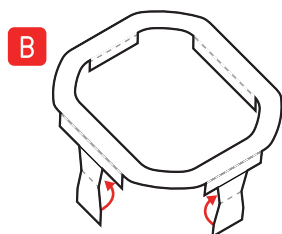

Fold into inside (4 points)

#### 5 Joint the bezel into the cut lines

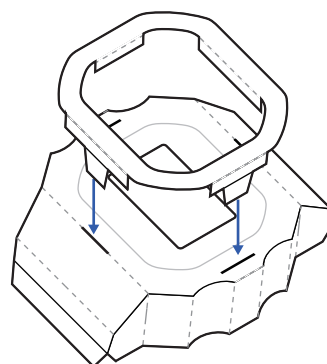

#### 6 Affix the bezel parts

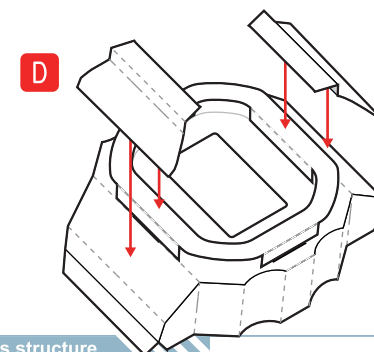

Tips for toughness structure

##### All directional covering

Knobby protrusions from the case and bezel protect the buttons and crystal from direct shocks.

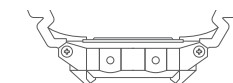

# G-SHOCK

## PAPER CRAFT

This model was designed for paper craft and may differ from the original in some respects.

Scale **1/1**

### DW-5600 Assembly instructions



Mountain fold  
(dashed line)



Valley fold  
(dotted and  
dashed line)

 Insert

 Apply glue

 Cut out

#### 7 Fold the front band

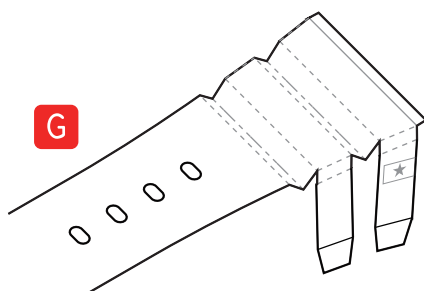

#### 8 Assemble the band

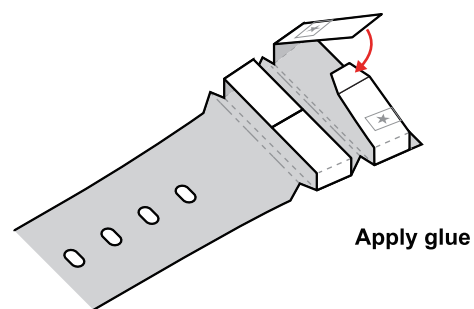

#### 9 Affix the rotation stopper to the band

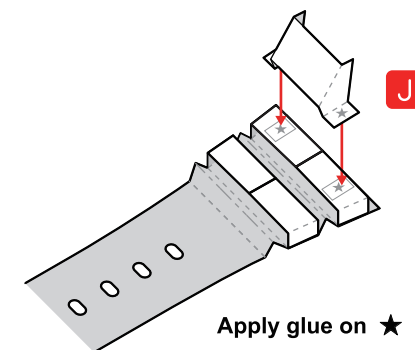

#### 10 Role the buckle pin

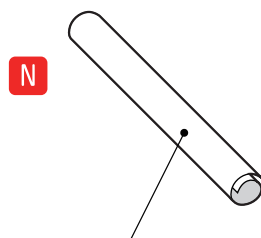

Roll into a cylinder with a diameter of about 2mm.  
(It is easy if you wrap around toothpick)

#### 11 Insert the buckle pin

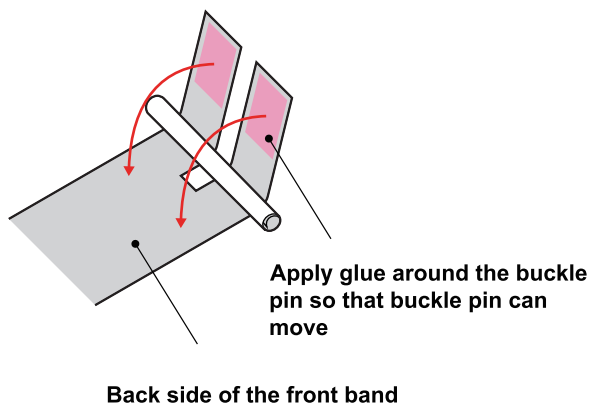

#### 12 Affix the buckle tongue

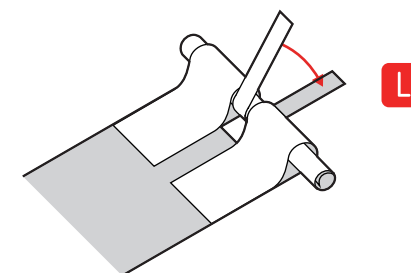

# G-SHOCK

## PAPER CRAFT

This model was designed for paper craft and may differ from the original in some respects.

Scale **1/1**

### DW-5600 Assembly instructions



Mountain fold  
(dashed line)



Valley fold  
(dotted and  
dashed line)

← Insert

← Apply glue

✂ Cut out

#### 13 Affix the buckle

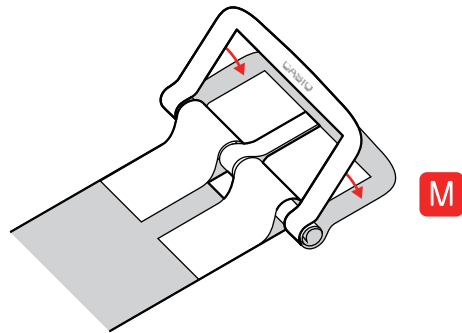

#### 14 Affix the back side of the band

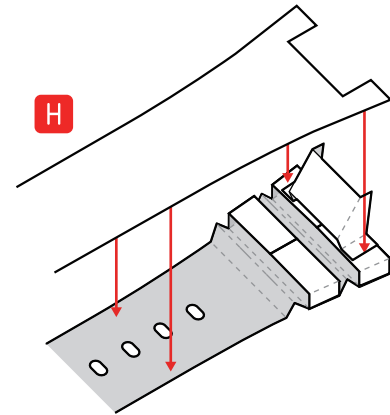

#### 15 Cut out the band holes

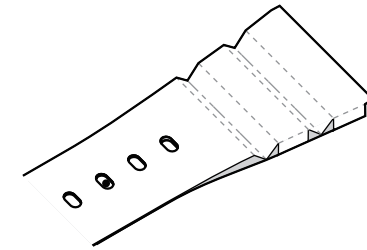

#### 16 Affix the band loop

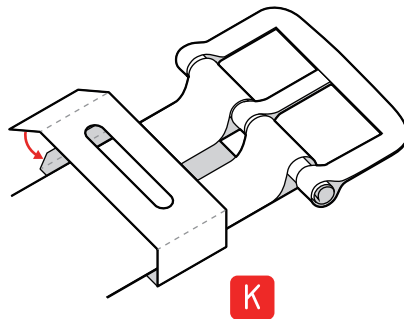

#### 17 Assemble the module

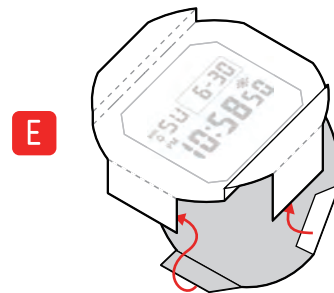

#### 18 Assemble the shock absorber

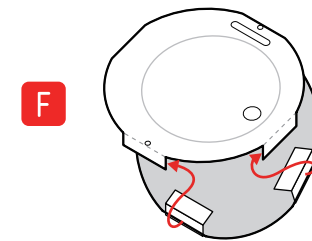

# G-SHOCK

## PAPER CRAFT

This model was designed for paper craft and may differ from the original in some respects.

Scale **1/1**

### DW-5600 Assembly instructions



Mountain fold  
(dashed line)

← Insert



Valley fold  
(dotted and  
dashed line)

← Apply glue



Cut out

#### 19 Affix the module to the case

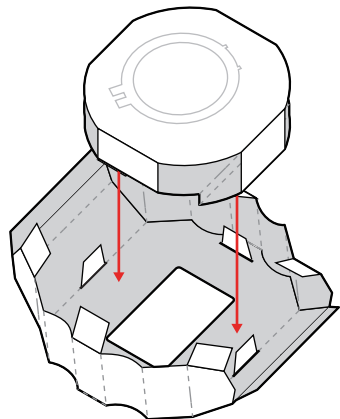

Apply glue on ★  
(Check the display position from the front side)

#### 20 Affix the shock absorber to the module

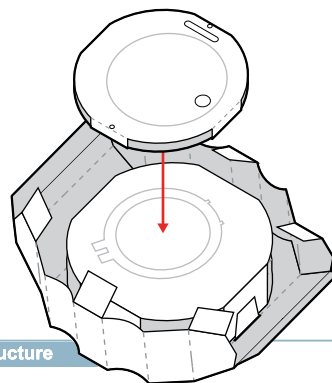

Tips for toughness structure

##### Hollow case structure

The module is floated in the air inside a case with a hollow structure.

#### 21 Affix the back panel to the case

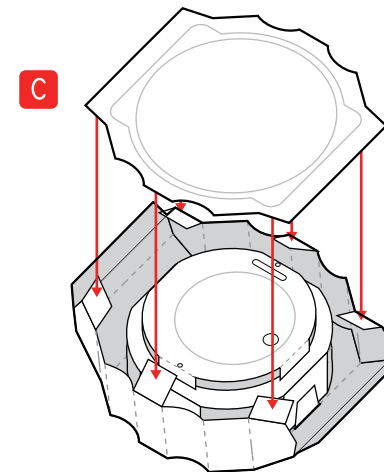

#### 22 Affix the band to the case

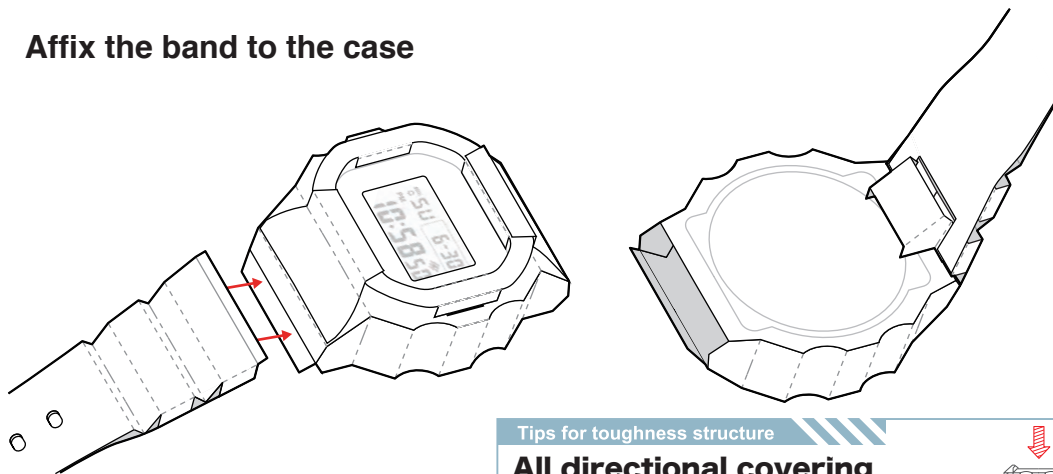

Tips for toughness structure

##### All directional covering

The band connection section is stiffly curved, moreover, to shield the back of the case against direct shocks.

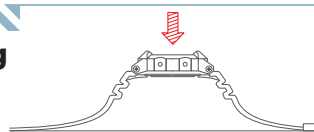

#### 23 Done!

